

# FG-SP4W\_AP CABINET LOUDSPEAKER



## PRODUCT OVERVIEW

This loudspeaker is a high-performance 6 W voice alarm cabinet loudspeaker. It provides a broad frequency response range, low distortion and high sound pressure level for accurate and intelligible broadcast of evacuation messages and high quality sound reproduction. It's ideal for sound distribution in various types of commercial buildings. Its low-profile, white color design blends easily with most interiors in locations such as hotels, conference rooms, cinemas, factories and exhibitions.

This voice alarm cabinet loudspeaker complies with BS5859 part 8 and EN54 part 24.



## Features

- Intelligible voice and superior sound reproduction
- Robust metal enclosure
- Harmonious with all indoor decoration
- Simple power setting
- Easy installation
- Complies with EN54-24 standard

## Installation/ Configuration notes

### Mounting

The loudspeaker is designed for quick and simple installation. First, mount the back on the wall or on the junction box using the rear screw slots. Cable can be entered from the rear or the side. Second, secure the grille cover with the three side screws.

### Power Setting

There are four primary taps including 6W, 3W, 1.5W and 0.75W for your selection. The cable connector is mounted on the back cover for easy installation.



0359  
19  
0359-CPR-XXXXX

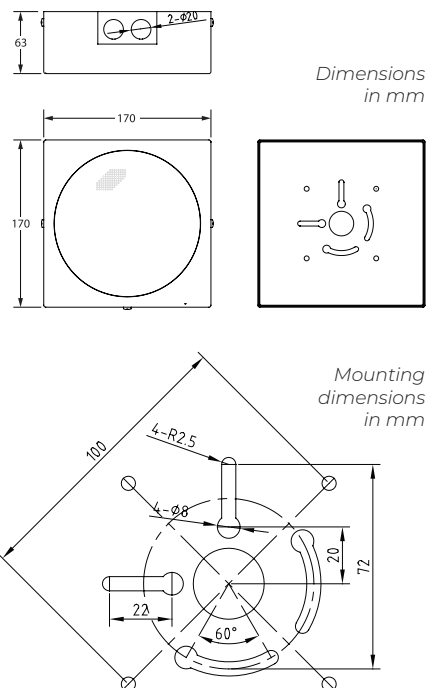

## Technical Specification

### Electrical

Max Power	9 W
Rated power	6 W
Power tapping	6 W / 3 W / 1.5 W / 0.75 W
Sensitivity (1W/4m, 100Hz-10k Hz)	79 dB
SPL (1W/1m, 100Hz-10k Hz)	91 dB
SPL (6W/4m, 100Hz-10k Hz)	86 dB
Frequency response (-10dB)	300 Hz - 15k Hz
Rated input voltage	100 V / 70 V
Rated Impedance (Ω)	1.7k / 3.3k / 6.7k / 13k
Connections	Ceramic terminals

### Mechanical

Dimensions	170mm x 170mm x 63mm
Weight	1.56 kg
Colour	White (RAL9003)
Speaker Size	4"

### Environment

Operating temperature	-25°C to +55°C
Storage temperature	-40°C to +70°C
Relative humidity	<95%

- \* The reference axis is perpendicular to the centre point of the front grill
- \* The reference plane is perpendicular to the centre of the reference axis
- \* The horizontal plane is perpendicular to the centre of the reference plane
- \* The spec/data was measured using a standard baffle mounting in a anechoic chamber as described in EN54-24

MODEL	DESCRIPTION
FG-SP4W_AP	4 Cabinet Loudspeaker



## FREQUENCY RESPONSE AT 100 VOLT/4M, 1/3 OCT SMOOTHING

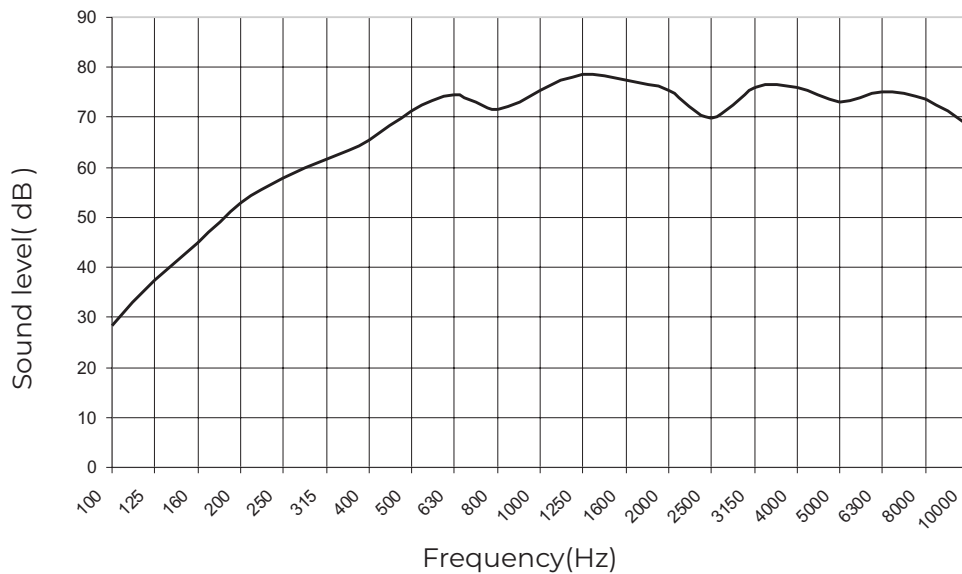

## WITH TRANSFORMER: 100V/70V LINE

	Red wire plus tapping				Black
100V	0.75W	1.5W	3W	6W	Com
70V	0.375W	0.75W	1.5W	3W	Com
IMP(Ω)	13K	6.7K	3.3K	1.7K	

## DISPERSION ANGLES

		Horizontal	Vertical
1 oct. pink noise	500 Hz	226°	226°
1 oct. pink noise	1k Hz	175°	174°
1 oct. pink noise	2k Hz	85°	88°
1 oct. pink noise	4k Hz	96°	85°

## CIRCUIT DIAGRAM

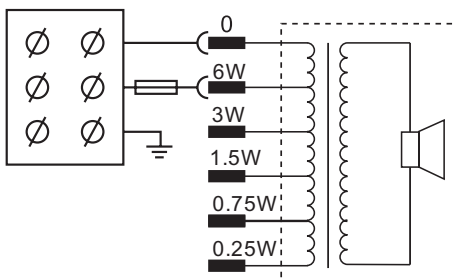

## THREE-VIEW DIAGRAM

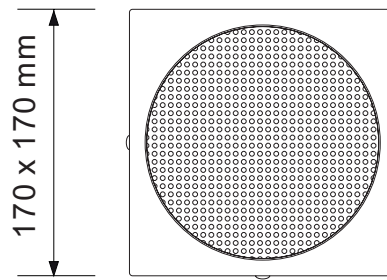

## INSTALLATION

1. Attach the cabinet to flat surface.

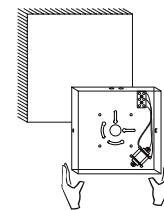

2. Fix the cabinet with screws.

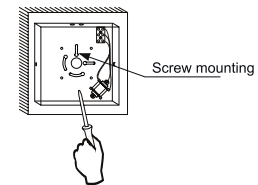

3. Select desired power and attach the front panel to the cabinet.

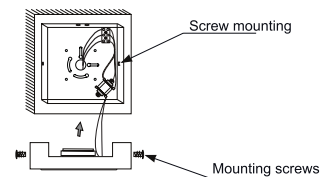

4. Fix the front panel to the cabinet with screws.

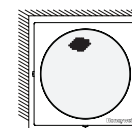

## POLAR DIAGRAM

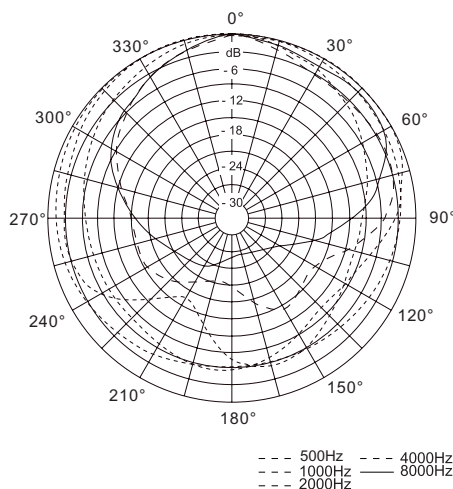

## FIREGUARD GLOBAL LTD.

Tel: 00-44-8450751042

Fax: 00-44-8459751043

Email: Info@Fireguard-Uk.com

www.fireguard-Uk.com



Unit 11 · Chancel Industrial Estate · Newhall Street  
Willenhall · WV13 1NX · United Kingdom



FS546607

